

# *Introduction to Permaculture*

*Presentation for Soil School 2017*

presentation by Marisha Auerbach  
Marisha.permaculturerising@gmail.com  
[permaculturerising.com](http://permaculturerising.com)

# What is Permaculture?

- ~ It is a design system for human settlement based on context.
- ~ Guided by the native ecology, we design our agricultural systems, gardens, lifestyle choices, and communities for good stewardship of our resources.
- ~ We begin with a thoughtful site analysis. We determine the unique climatic considerations, resources, limiting factors, to guide meeting the needs of inhabitants onsite.
- ~ Permaculture design strives to meet human needs locally while caring for the other species and neighboring communities.



*Similar to the relationship of indigenous cultures with their place, our resilience comes from understanding & embracing our interdependence.*



**Mayan People**

**Chickasaw People**

**Chehalis People**

**Hmong People**

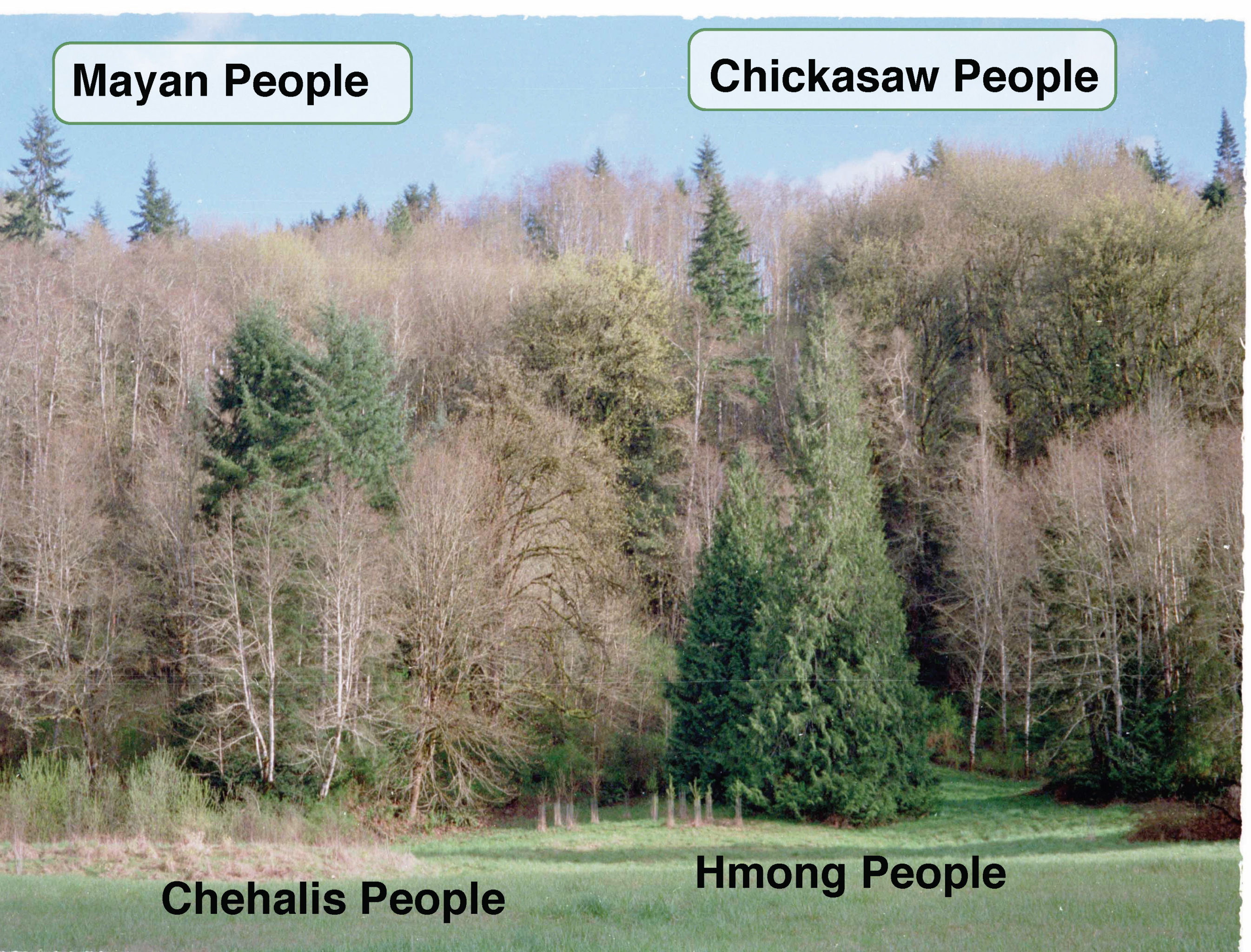



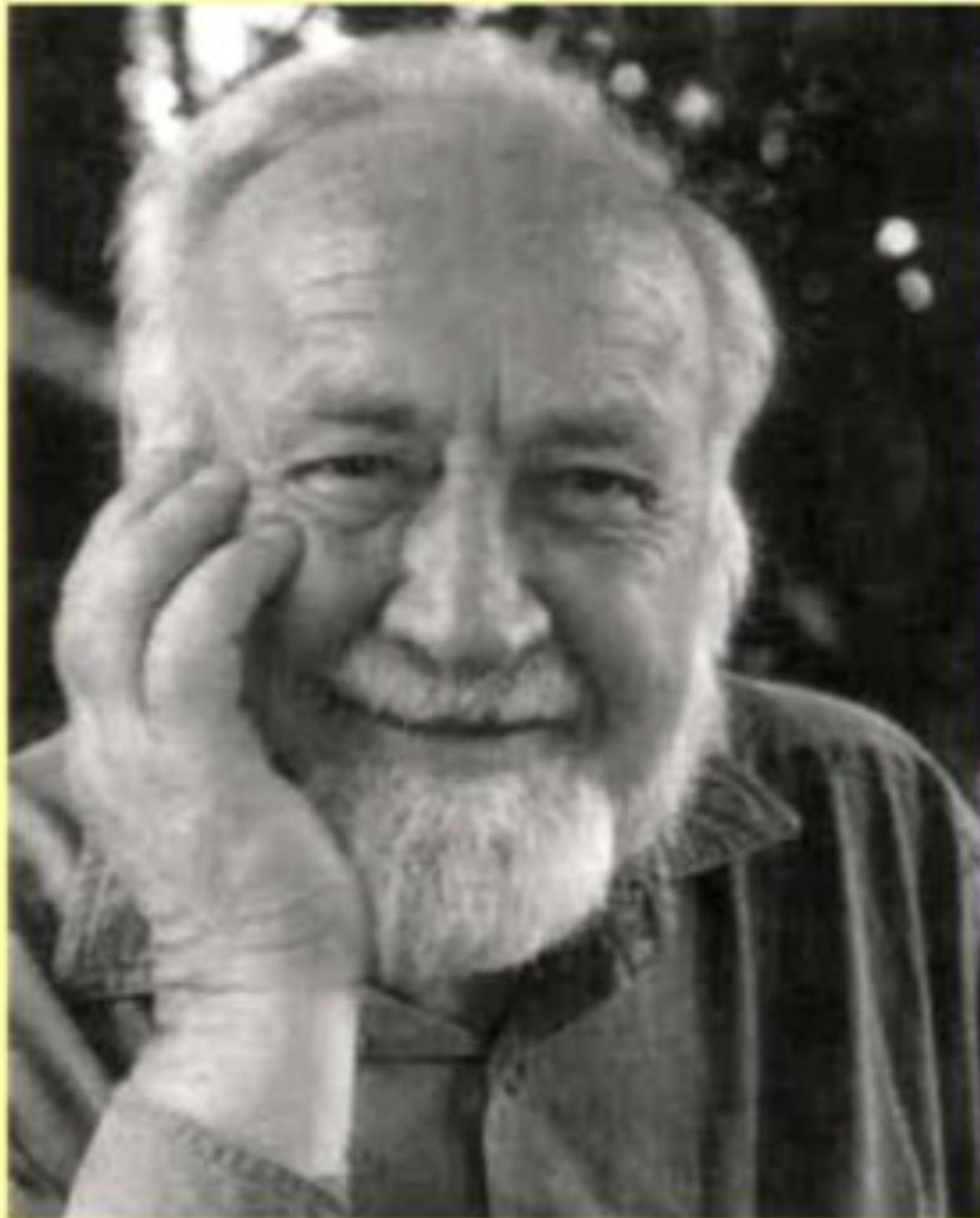

“Permaculture is a philosophy of working with, rather than against nature; of protracted & thoughtful observation rather than protracted & thoughtless action; of looking at systems in all their functions rather than asking only one yield of them & of allowing systems to demonstrate their own evolutions.”

Bill Mollison



**Bill Mollison**



**Masanobu Fukuoka**

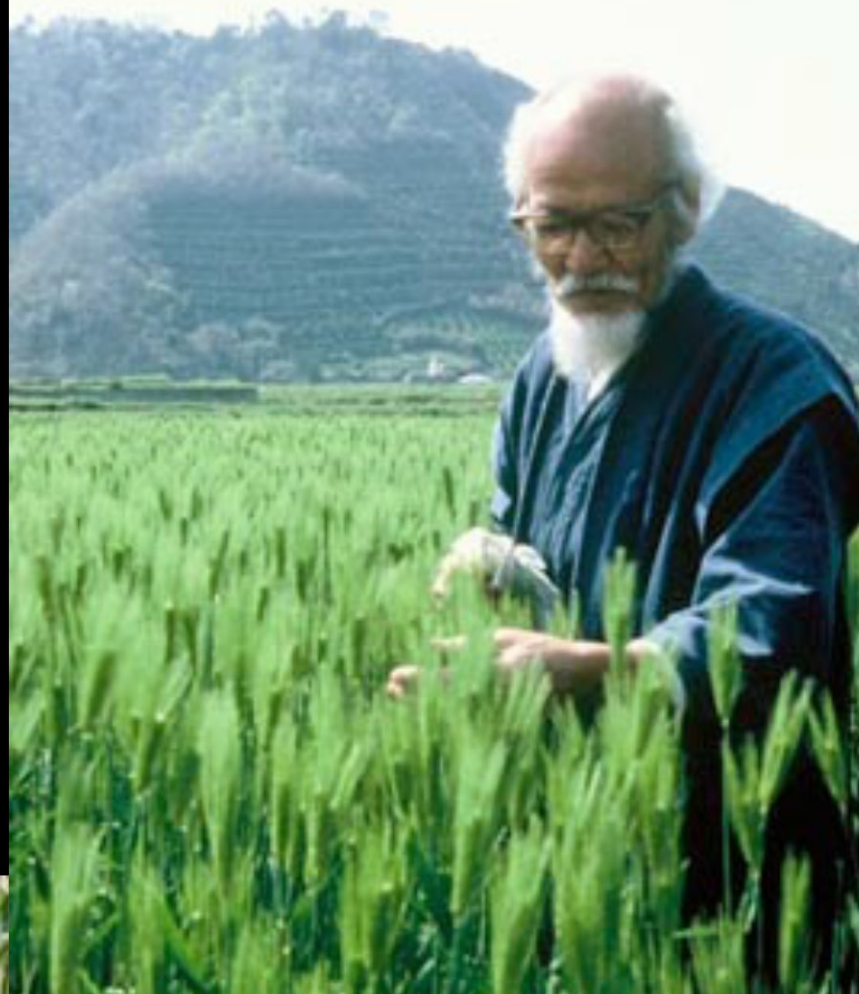

**David Holmgren & Sue Dennet**



**Rosemary Morrow & Robyn Francis**







**Creatively use &  
respond to change**



**Use edges &  
value the  
marginal**



**Observe &  
interact**

**Use & value  
diversity**



**Catch & store  
energy**

**Use small &  
slow solutions**



**Obtain a yield**

**Integrate rather  
than segregate**



**Apply self-  
regulation &  
accept feedback**

**Design from  
patterns to  
details**



**Produce no waste**



**Use & value  
renewable resources  
& services**



# Permaculture Flower

The permaculture journey begins with the Ethics and Design Principles and moves through the key domains required to create a sustainable culture. The spiral evolutionary path joins together these domains, initially at a personal and local level, and then proceeding to the collective and global level.

Some of the specific fields, design systems and solutions that have been associated with the wider view of permaculture are listed below.

## Land & Nature Stewardship

Bio-intensive gardening	Holistic Rangeland Management
Forest gardening	Natural Sequence Farming
Seed saving	Agroforestry
Organic agriculture	Nature-based forestry
Biodynamics	Integrated aquaculture
Natural Farming	Wild harvesting & hunting
Keyline water harvesting	Gleaning

## Building

Passive solar design	Earth sheltered construction
Natural construction materials	Natural disaster resistant construction
Water harvesting & Waste Reuse	Owner building
Biotechnology	Pattern Language

## Tools & Technology

Reuse & creative recycling	Bio-char from forest wastes
Hand tools	Co-generation
Bicycles and electric bikes	Micro-hydro & small scale wind
Efficient & low pollution wood stoves	Grid-tied renewable power generation
Fuels from organic wastes	Energy storage
Wood Gasification	Transition engineering

## Education & Culture

Home Schooling	Social ecology
Waldorf education	Action Research
Participatory arts and music	Transition culture

## Health & Spiritual Well-Being

Home birth & Breast feeding	Spirit of place, indigenous
Complementary & Wholistic Medicine	cultural revival
Yoga, Tai Chi & other	Dying with dignity
body/mind/spirit disciplines	

## Finances & Economics

Local and regional currencies	WWOOFing & similar networks
Carpooling, Ride sharing & Car share	Tradable Energy Quotas
Ethical Investment & Fair Trade	Life Cycle Analysis & Energy
Farmers markets & Community	Accounting
Supported Agriculture (CSA)	

## Land Tenure & Community Governance

Cooperatives & Body Corporates	Open Space Technology &
Cohousing & Ecovillages	Consensus Decision Making
Native Title and traditional use rights	

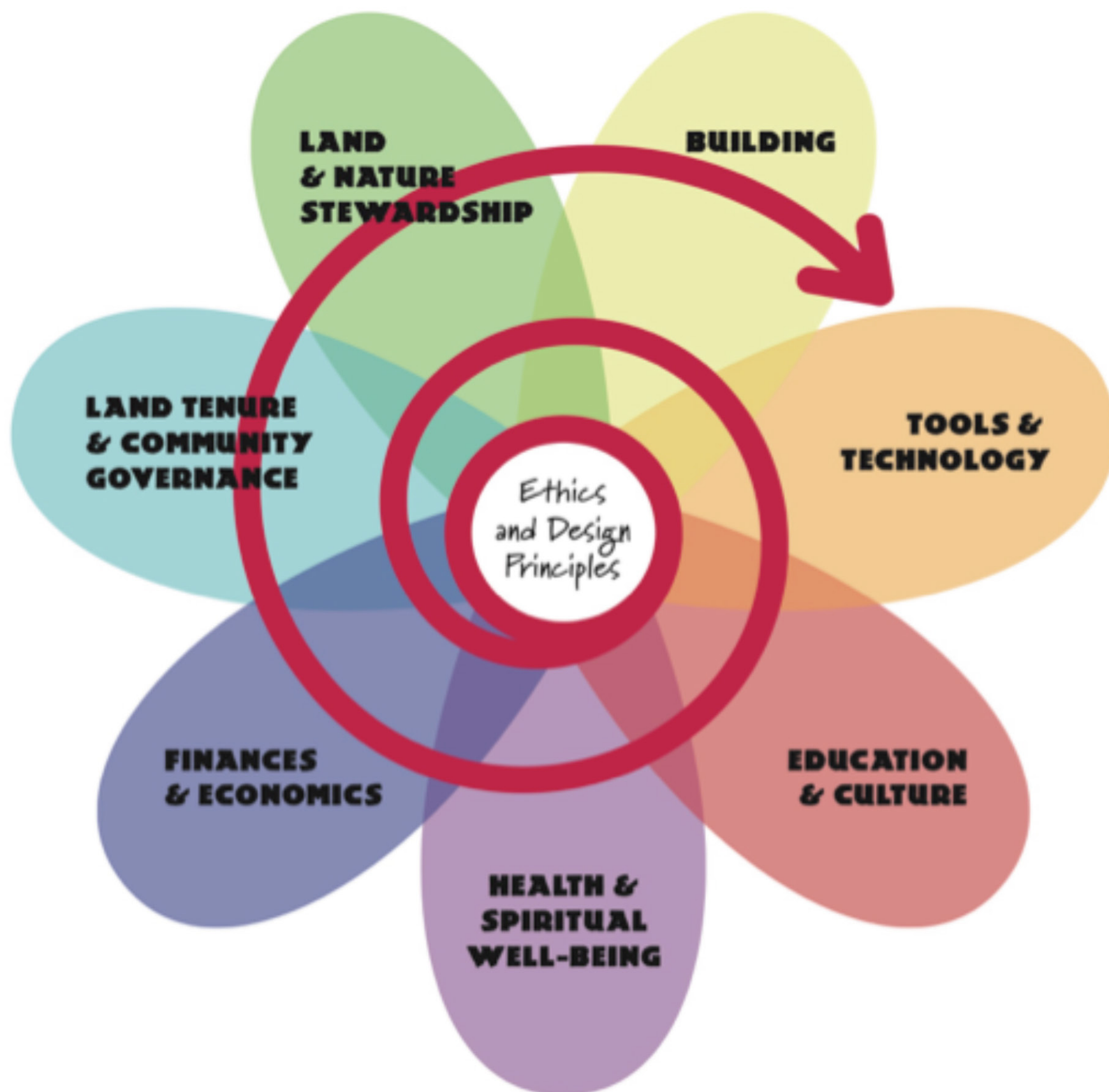

This work is licensed under the Creative Commons Attribution-NonCommercial-NoDerivs 4.0 International license. To view a copy of this license, visit <http://creativecommons.org/licenses/by-nc-nd/4.0/> or send a letter to Creative Commons, 171 Second Street, Suite 300, San Francisco, California, 94105, USA. The 'Permaculture Flower' has been adapted from David Holmgren's book 'Permaculture: Principles & Pathways Beyond Sustainability'. Permaculture Flower Poster 1.0





## **The Prime Directive of Permaculture:**

***The only ethical decision  
is to take responsibility  
for our own existence and  
that of our children.***



They paved Paradise and put up a Parking Lot.....





BẢNG THIẾT KẾ Ý TƯỞNG TRONG TƯƠNG LAI KHU NHÀ NGHỈ

The above  
to the 1st of  
2nd of  
3rd of  
4th of  
5th of  
6th of  
7th of  
8th of  
9th of  
10th of

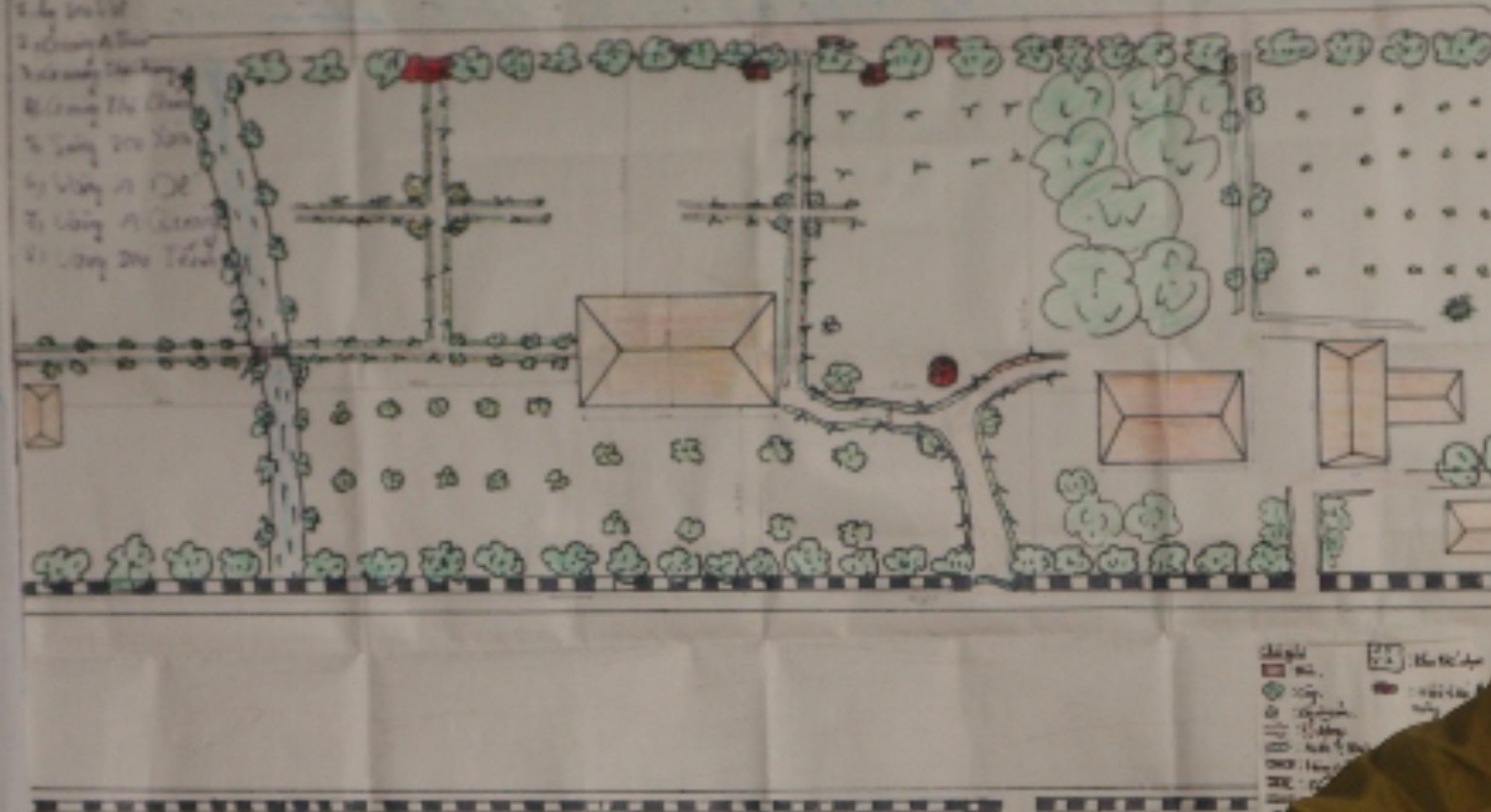

# HEPA Farmer Field School, Ha Tinh Province, Vietnam

19 15:40





**Maya Mountain Research Farm,  
Toledo District, Belize**



Average high temp. in summer: 77 degrees  
Average low temp. in winter: 38 degrees

Record Low Temp. = - 3 F

Average last frost: April 26

Portland, OR	Jan	Feb	March	April	May	June	July	August	Sept	Oct	Nov	Dec
High Temp:	45	51	56	60	67	74	78	80	74	62	52	45
Low Temp:	34	37	38	41	47	52	56	56	52	44	38	34
Precip.:	5.4	3.9	3.6	2.4	2.1	1.5	.6	1.1	1.8	2.7	5.3	6.1

## Annual Rainfall: 37.5"





Imagery Date: 7/8/2010

2012 Google  
44°31'00.16" N 123°17'29.88" W elev 72 m

Google earth

Eye alt 2.71 km



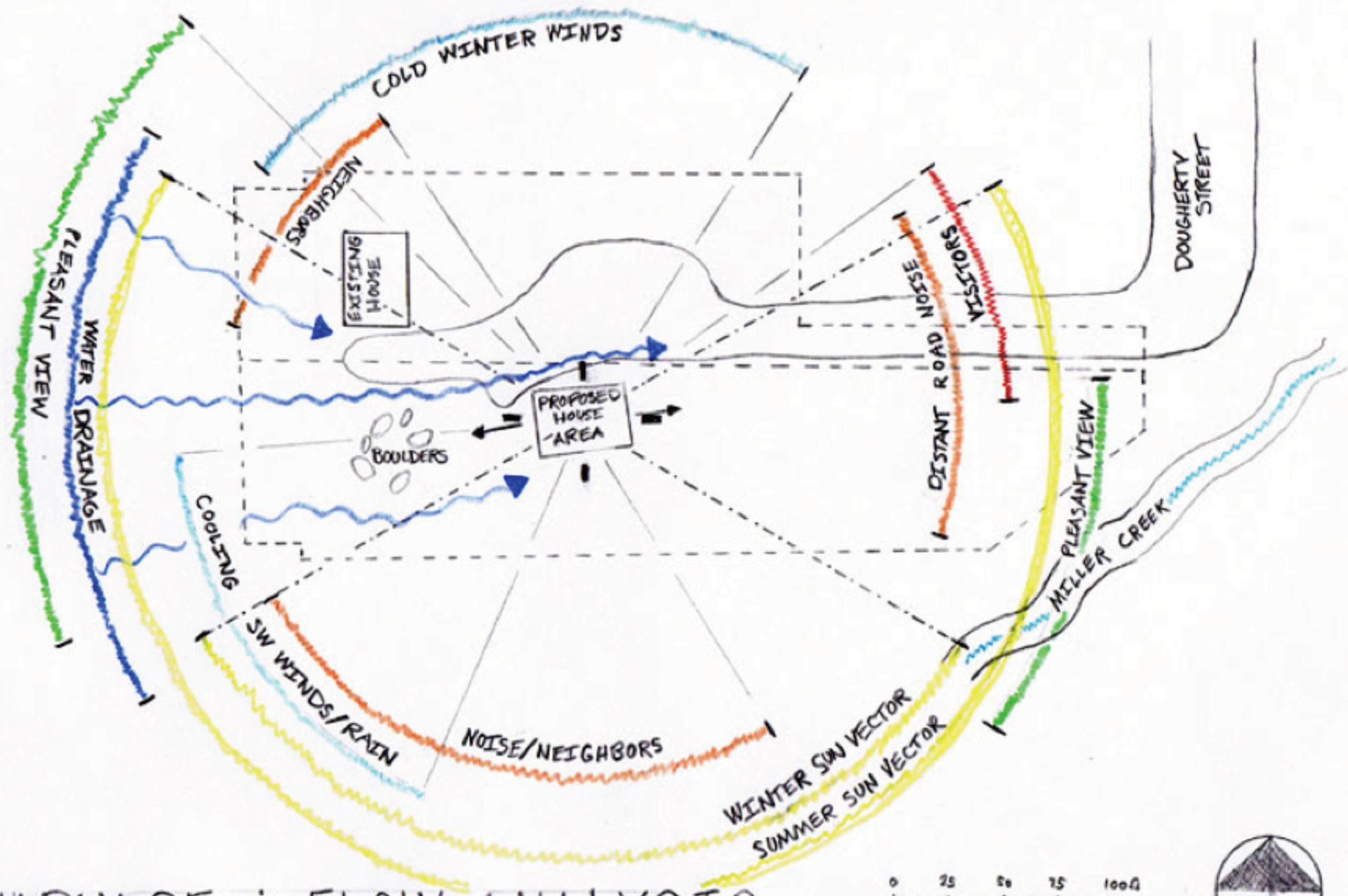

# IMPULSE & FLOW ANALYSIS





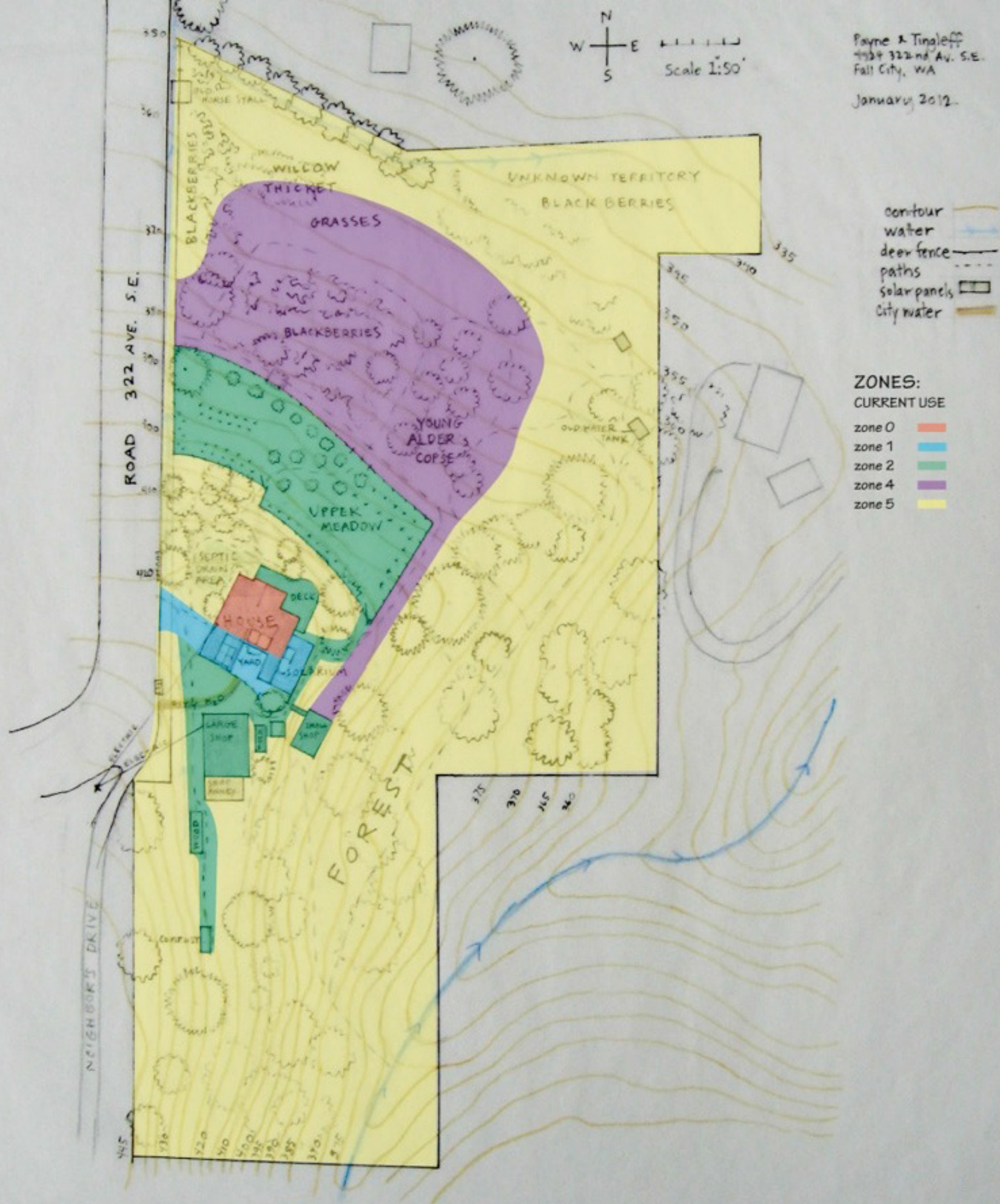

# Zones of Relationship



## List Elements

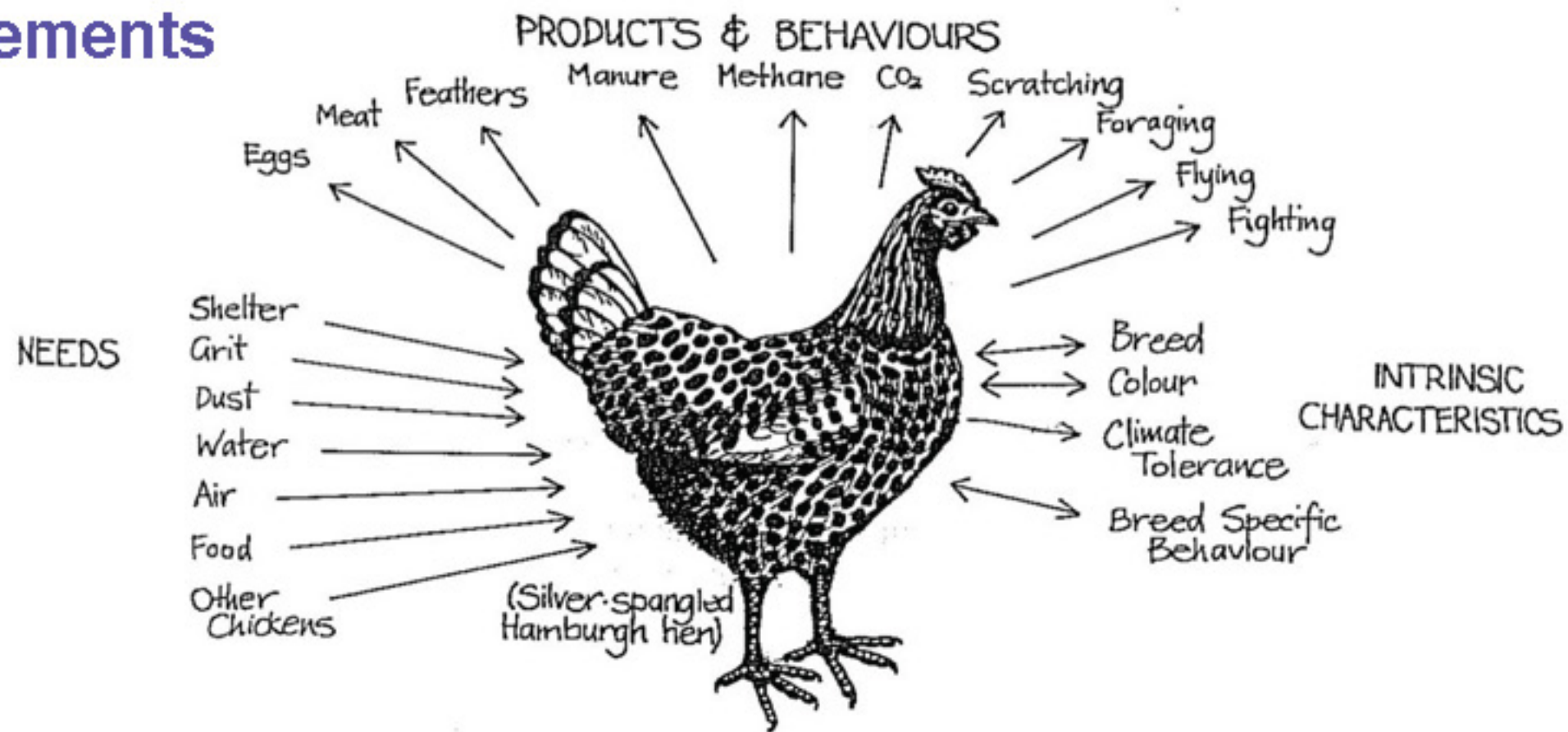

## Assemble based on beneficial relationships

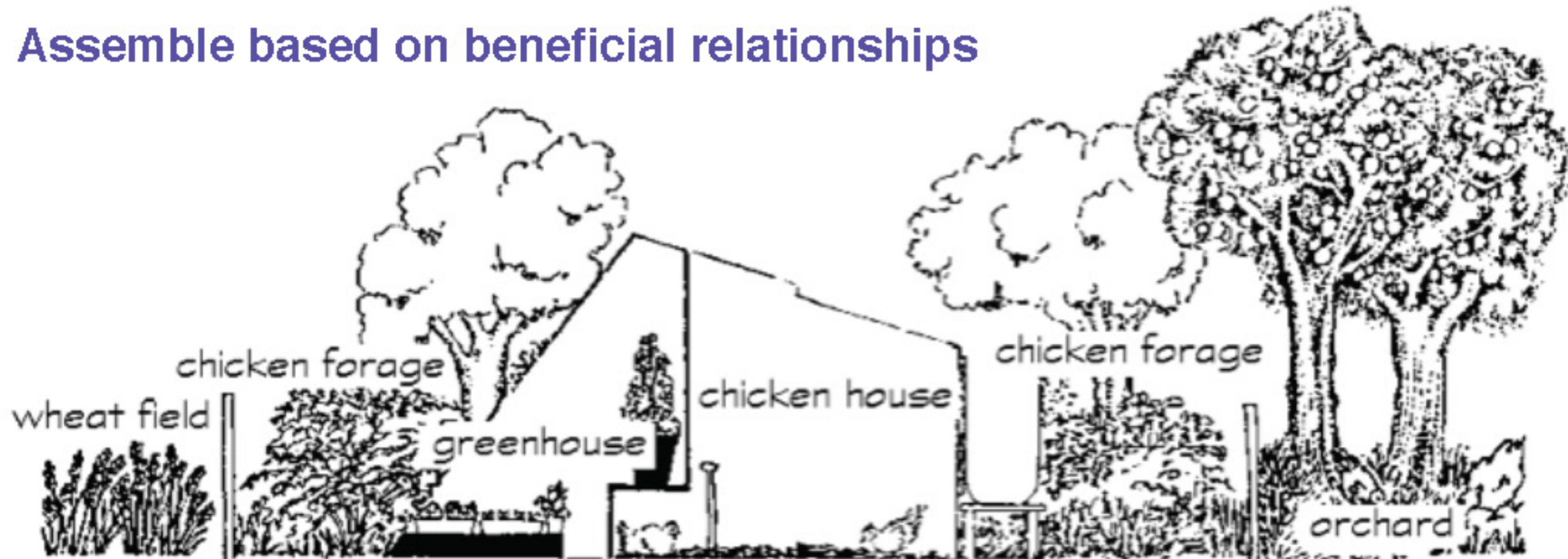



# 1 IN 6 AMERICANS STRUGGLES WITH HUNGER.

VISIT [FEEDINGAMERICA.ORG](http://FEEDINGAMERICA.ORG)

TOGETHER  
WE'RE

FEEDING  
AMERICA



Food Share, Inc. of Ventura County  
Los Angeles Regional Foodbank  
Second Harvest Food Bank of Orange County  
Second Harvest Food Bank Serving Riverside and San Bernardino Counties

CLEARCHANNEL DIGITAL

- \* 1 in 4 children do not have enough to eat.
- \* Many individuals who struggle with hunger are working and not homeless.
- \* More than 2 million rural households experience food insecurity.
- \* Hunger is increasing at an alarming rate in America.

Source: Feeding America: <http://feedingamerica.org/hunger-in-america.aspx>



# Design From Patterns to Details

Eggs, fruit, and vegetables have the most volatile prices

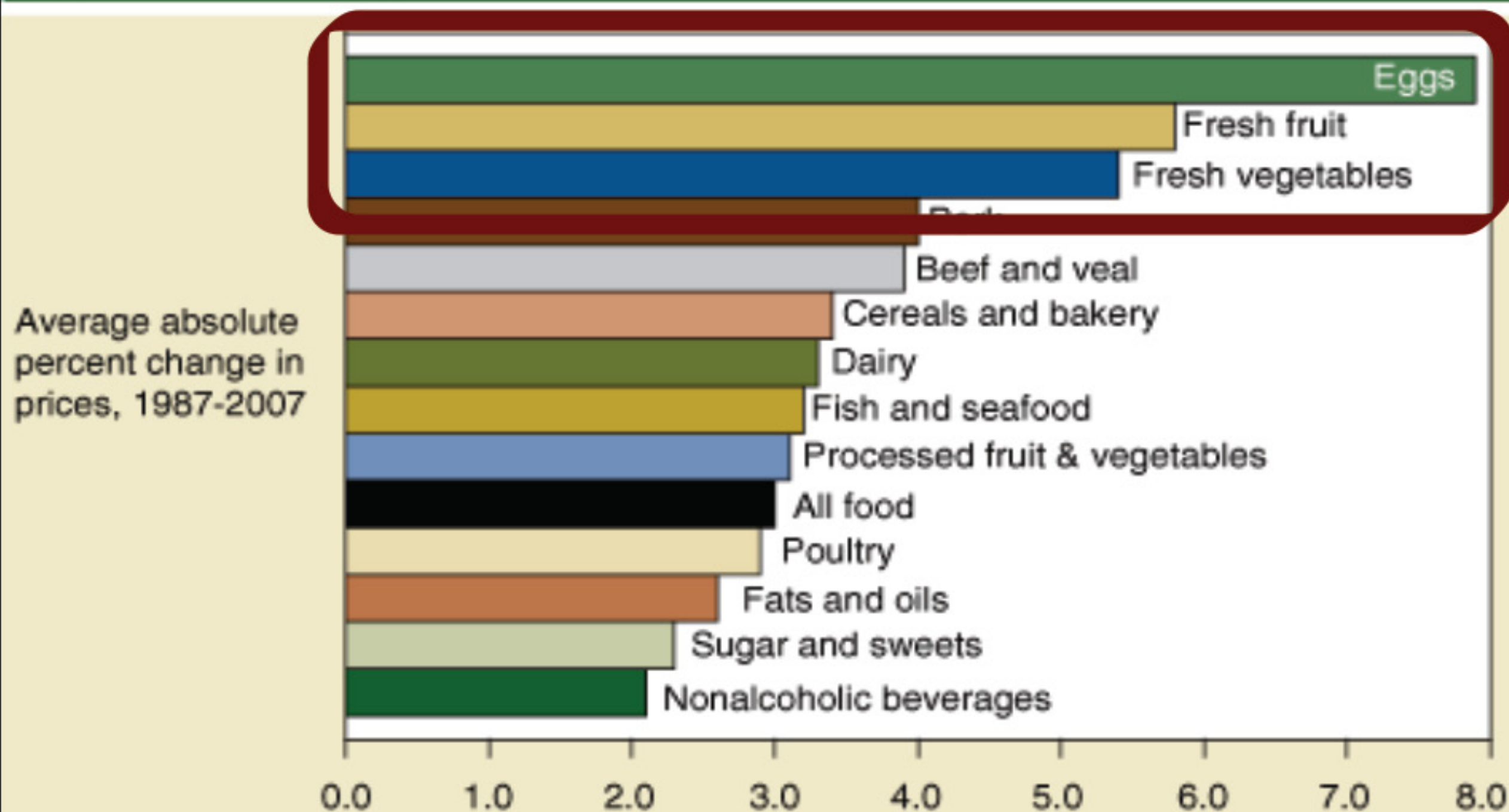

Source: ERS calculations using Bureau of Labor Statistics' Consumer Price Index data.



# Bunny Love Carrots, New Cuyama, CA





